

VÉRTICES 200 x 200 x 10/30

units: mm

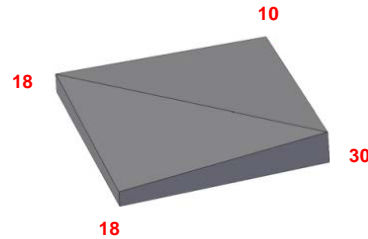
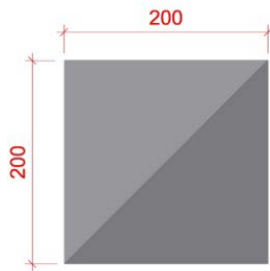

Thickness \approx 10/30 mm

Piece Dimensions

Piece photo

Given the characteristics of aggregates and their photographic reproduction, there may be slight variations in particle size and tone.

Available Colors



VERTICES VT27

Product characteristics and package

Technical Specifications

Product Type	Flat Elements	Product Classification	EN 14618	Concrete Coating
Quantity per Pallet	38,4 sqm	Surface Quality	EN 14617-16	Visual Inspection
Quantity per Box	0,48 sqm	Dimensions and Geometry	EN 14617-16	Tolerances \pm 5 mm
Items/sqm	25 Units	Maximum Water Absorption	EN 14617-1	\leq 8 %
Items/Box	12 Units	Average Apparent Density	EN 14617-1	2200 \pm 50 kg/m ³
Boxes/Pallet	80 Boxes	Freeze/Thaw Resistance	EN 14617-5	Pass
Average weight/sqm	45 kg	Flexural Strength (after 25 cycles)	EN 14617-2	No change
Average weight/Box	21,6 kg	Thermal Shock Resistance	EN 14617-6	Pass
Average weight/Pallet	1760 kg With Pallet	Flexural Strength (after 20 cycles)	EN 14617-2	No change
Approved: Vitor Silva	Elaborate: Bruno Veloso	Minimum Flexural Strength	EN 14617-2	7 MPa
		Compressive Strength Class	EN 206	C30/37
		Minimum Compressive Strength	EN 12390-3	\geq 37 N/mm ²
		Water Absorption by Capillary	EN 772-11	\leq 1 g/(m ² .s)
		PTDS n°: VER_001_EN		Date: 27/09/2019